

H:\10000 - H Drive\pmpinson\Autocad\19-30410-LK-RC1 - Scheme Plan.dwg - Plotted: 1/10/2020

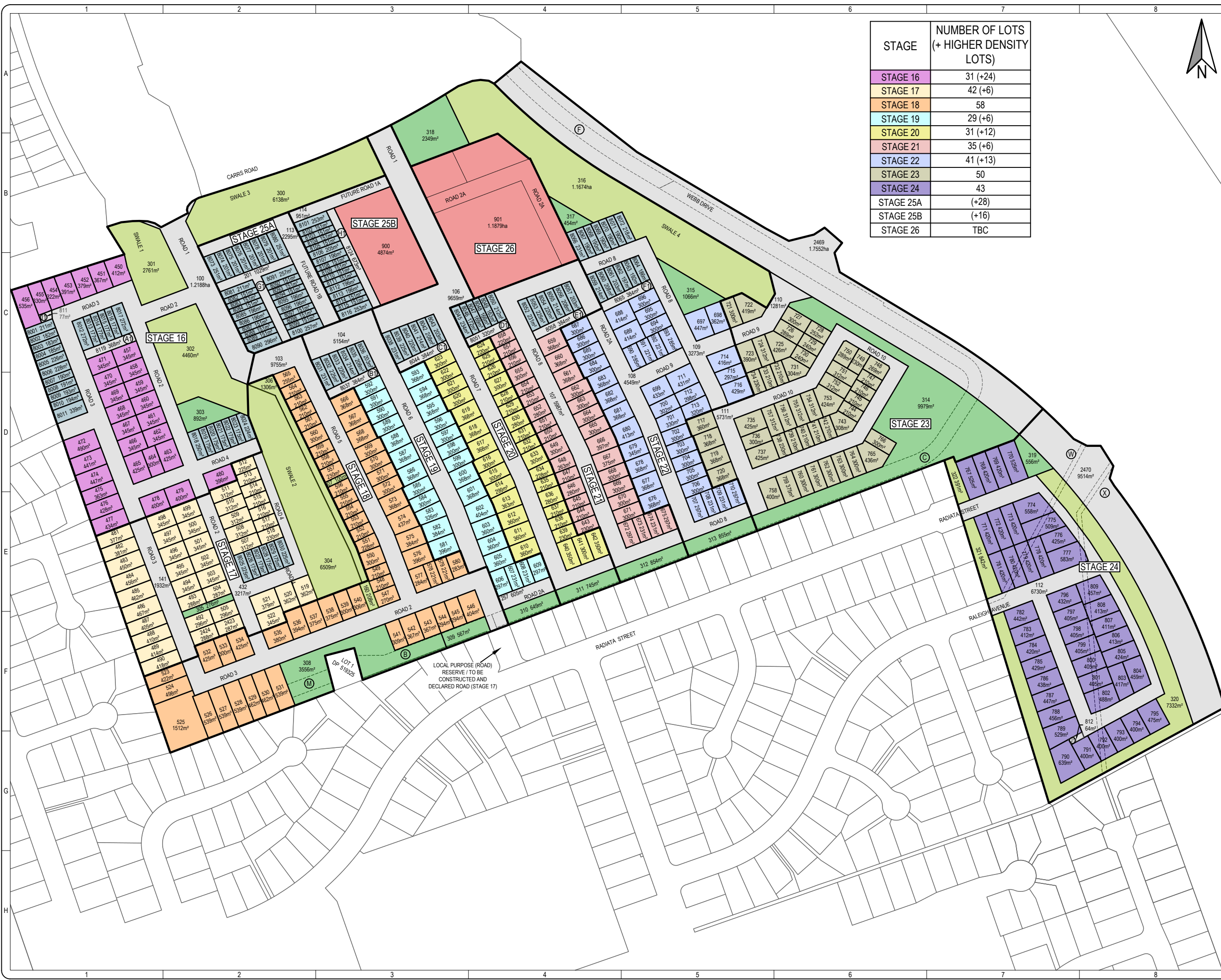

STAGE	NUMBER OF LOTS (+ HIGHER DENSITY LOTS)
STAGE 16	31 (+24)
STAGE 17	42 (+6)
STAGE 18	58
STAGE 19	29 (+6)
STAGE 20	31 (+12)
STAGE 21	35 (+6)
STAGE 22	41 (+13)
STAGE 23	50
STAGE 24	43
STAGE 25A	(+28)
STAGE 25B	(+16)
STAGE 26	TBC



SHRIMPTON & LIPINSKI
 LAND DEVELOPMENT &
 DESIGN SPECIALISTS
 Ph. 07 577 6069
 Email: info@sltga.co.nz
 P.O. Box 231, Tauranga 3140
 www.sltga.co.nz

NOTES:

- THIS PLAN HAS BEEN PREPARED FOR THE PURPOSES OF SECTION 88 OF THE RESOURCE MANAGEMENT ACT 1991 AND SHOULD NOT BE RELIED ON FOR ANY OTHER PURPOSE.
- AREAS AND DIMENSIONS ARE APPROXIMATE ONLY AND SUBJECT TO SURVEY.
- ALL ROADS (LOTS 100-116) ARE TO BE VESTED IN HAMILTON CITY COUNCIL.
- ALL RESERVES (LOT 300-324) ARE TO BE VESTED IN HAMILTON CITY COUNCIL.

LEGEND:

- LOT BOUNDARY
- PROPOSED CADASTRAL LAYOUT
- CONCEPT BOUNDARY
- STAGE BOUNDARY
- ABUTTALS
- EXISTING EASEMENTS
- MIXED USE LOTS
- HIGHER DENSITY LOTS
- RECREATION RESERVE
- STORMWATER RESERVE
- ROAD RESERVE

SEE 19-30410-LK-RC2 FOR SCHEDULES AND AMALGAMATION CONDITIONS

Rev	DESCRIPTION	DRN	CKD	APP	DATE
6	STGS 16, 20 & 21 AMENDED	NW	NF	NF	04/20
7	SECTION 92 RESPONSE	NW	JL	NF	08/20
8	LOT LAYOUT UPDATED 92	JL	JL	NF	08/20
9	LOT LAYOUT UPDATED 92	JL	JL	NF	08/20
10	LOT LAYOUT UPDATED 92	JL	JL	NF	08/20
11	LOT LAYOUT UPDATED 92	JL	JL	NF	08/20
12	SCHEME DETAIL UPDATED	NP	JL	NF	09/20

NAME	DATE	NAME	DATE
SURVEYED		DESIGNED	

COORDINATE SYSTEM: NZGD 2000 (MOUNT EDEN)
 ORIGIN OF COORDINATES:
 HEIGHT DATUM: MOUTRIKI LVD 1953
 ORIGIN OF HEIGHT:
 TITLE

AREAS LU & K SCHEME PLAN

PREPARED FOR



AREAS LU & K

ORIGINAL SCALES @ A3 STATUS

1:3000 FOR APPROVAL

DO NOT SCALE DIMENSIONS

DRAWING NO: **19-30410-LK-RC1** REVISION: **12**

COPYRIGHT ON THIS DRAWING IS RESERVED

H:\10000 - H Drive\parksinson\Autocad\19-30410-LK-RC1 - Scheme Plan\19-30410-01 - Scheme Plan.dwg - Plotted: 1/10/2020

AMALGAMATION CONDITIONS:

THAT LOT 8119 HEREON (LEGAL ACCESS) BE HELD AS TO SIX UNDIVIDED ONE SIXTH SHARES BY THE OWNERS OF LOTS 8012, 8013, 8014, 8015, 8016 & 8017 HEREON AND INDIVIDUAL RECORDS OF TITLE BE ISSUED IN ACCORDANCE THEREWITH.

THAT LOT 8037 HEREON (LEGAL ACCESS) BE HELD AS TO SIX UNDIVIDED ONE SIXTH SHARES BY THE OWNERS OF LOTS 8031, 8032, 8033, 8034, 8035 & 8036 HEREON AND INDIVIDUAL RECORDS OF TITLE BE ISSUED IN ACCORDANCE THEREWITH.

THAT LOT 8044 HEREON (LEGAL ACCESS) BE HELD AS TO SIX UNDIVIDED ONE SIXTH SHARES BY THE OWNERS OF LOTS 8038, 8039, 8040, 8041, 8042 & 8043 HEREON AND INDIVIDUAL RECORDS OF TITLE BE ISSUED IN ACCORDANCE THEREWITH.

THAT LOT 8051 HEREON (LEGAL ACCESS) BE HELD AS TO SIX UNDIVIDED ONE SIXTH SHARES BY THE OWNERS OF LOTS 8045, 8046, 8047, 8048, 8049 & 8050 HEREON AND INDIVIDUAL RECORDS OF TITLE BE ISSUED IN ACCORDANCE THEREWITH.

THAT LOT 8058 HEREON (LEGAL ACCESS) BE HELD AS TO SIX UNDIVIDED ONE SIXTH SHARES BY THE OWNERS OF LOTS 8052, 8053, 8054, 8055, 8056 & 8057 HEREON AND INDIVIDUAL RECORDS OF TITLE BE ISSUED IN ACCORDANCE THEREWITH.

THAT LOT 8065 HEREON (LEGAL ACCESS) BE HELD AS TO SIX UNDIVIDED ONE SIXTH SHARES BY THE OWNERS OF LOTS 8059, 8060, 8061, 8062, 8063 & 8064 HEREON AND INDIVIDUAL RECORDS OF TITLE BE ISSUED IN ACCORDANCE THEREWITH.

THAT LOT 201 HEREON (LEGAL ACCESS) BE HELD AS TO TWENTY EIGHT UNDIVIDED ONE TWENTY EIGHTH SHARES BY THE OWNERS OF LOTS 8073, 8074, 8075, 8076, 8077, 8078, 8079, 8080, 8081, 8082, 8083, 8084, 8085, 8086, 8087, 8088, 8089, 8090, 8091, 8092, 8093, 8094, 8095, 8096, 8097, 8098, 8099 & 8100 HEREON AND INDIVIDUAL RECORDS OF TITLE BE ISSUED IN ACCORDANCE THEREWITH.

THAT LOT 8124 HEREON (LEGAL ACCESS) BE HELD AS TO SIXTEEN UNDIVIDED ONE SIXTEENTH SHARES BY THE OWNERS OF LOTS 8101, 8102, 8103, 8104, 8105, 8106, 8107, 8108, 8109, 8110, 8111, 8112, 8113, 8114, 8115 & 8116 HEREON AND INDIVIDUAL RECORDS OF TITLE BE ISSUED IN ACCORDANCE THEREWITH.

THAT LOT 8001 & 8002 HEREON BE HELD IN THE SAME RECORD OF TITLE

THAT LOT 8003 & 8004 HEREON BE HELD IN THE SAME RECORD OF TITLE

THAT LOT 8005 & 8006 HEREON BE HELD IN THE SAME RECORD OF TITLE

THAT LOT 8007 & 8008 HEREON BE HELD IN THE SAME RECORD OF TITLE

THAT LOT 8009, 8010 & 8011 HEREON BE HELD IN THE SAME RECORD OF TITLE

THAT LOT 8012 & 8013 HEREON BE HELD IN THE SAME RECORD OF TITLE

THAT LOT 8014 & 8015 HEREON BE HELD IN THE SAME RECORD OF TITLE

THAT LOT 8016 & 8017 HEREON BE HELD IN THE SAME RECORD OF TITLE

THAT LOT 8018 & 8019 HEREON BE HELD IN THE SAME RECORD OF TITLE

THAT LOT 8020 & 8021 HEREON BE HELD IN THE SAME RECORD OF TITLE

THAT LOT 8022, 8023 & 8024 HEREON BE HELD IN THE SAME RECORD OF TITLE

THAT LOT 8025 & 8026 HEREON BE HELD IN THE SAME RECORD OF TITLE

THAT LOT 8027 & 8028 HEREON BE HELD IN THE SAME RECORD OF TITLE

THAT LOT 8029 & 8030 HEREON BE HELD IN THE SAME RECORD OF TITLE

THAT LOT 8031 & 8032 HEREON BE HELD IN THE SAME RECORD OF TITLE

THAT LOT 8033 & 8034 HEREON BE HELD IN THE SAME RECORD OF TITLE

THAT LOT 8035 & 8036 HEREON BE HELD IN THE SAME RECORD OF TITLE

THAT LOT 8038 & 8039 HEREON BE HELD IN THE SAME RECORD OF TITLE

THAT LOT 8040 & 8041 HEREON BE HELD IN THE SAME RECORD OF TITLE

THAT LOT 8042 & 8043 HEREON BE HELD IN THE SAME RECORD OF TITLE

THAT LOT 8045 & 8046 HEREON BE HELD IN THE SAME RECORD OF TITLE

THAT LOT 8047 & 8048 HEREON BE HELD IN THE SAME RECORD OF TITLE

THAT LOT 8049 & 8050 HEREON BE HELD IN THE SAME RECORD OF TITLE

THAT LOT 8052 & 8053 HEREON BE HELD IN THE SAME RECORD OF TITLE

THAT LOT 8054 & 8055 HEREON BE HELD IN THE SAME RECORD OF TITLE

THAT LOT 8056 & 8057 HEREON BE HELD IN THE SAME RECORD OF TITLE

THAT LOT 8059 & 8060 HEREON BE HELD IN THE SAME RECORD OF TITLE

THAT LOT 8061 & 8062 HEREON BE HELD IN THE SAME RECORD OF TITLE

THAT LOT 8063 & 8064 HEREON BE HELD IN THE SAME RECORD OF TITLE

THAT LOT 8066 & 8067 HEREON BE HELD IN THE SAME RECORD OF TITLE

THAT LOT 8068 & 8069 HEREON BE HELD IN THE SAME RECORD OF TITLE

THAT LOT 8070, 8071 & 8072 HEREON BE HELD IN THE SAME RECORD OF TITLE

THAT LOT 8073 & 8074 HEREON BE HELD IN THE SAME RECORD OF TITLE

THAT LOT 8075 & 8076 HEREON BE HELD IN THE SAME RECORD OF TITLE

THAT LOT 8077 & 8078 HEREON BE HELD IN THE SAME RECORD OF TITLE

THAT LOT 8079 & 8080 HEREON BE HELD IN THE SAME RECORD OF TITLE

THAT LOT 8081 & 8082 HEREON BE HELD IN THE SAME RECORD OF TITLE

THAT LOT 8083 & 8084 HEREON BE HELD IN THE SAME RECORD OF TITLE

THAT LOT 8085 & 8086 HEREON BE HELD IN THE SAME RECORD OF TITLE

THAT LOT 8087 & 8088 HEREON BE HELD IN THE SAME RECORD OF TITLE

THAT LOT 8089 & 8090 HEREON BE HELD IN THE SAME RECORD OF TITLE

THAT LOT 8091 & 8092 HEREON BE HELD IN THE SAME RECORD OF TITLE

THAT LOT 8093 & 8094 HEREON BE HELD IN THE SAME RECORD OF TITLE

THAT LOT 8095 & 8096 HEREON BE HELD IN THE SAME RECORD OF TITLE

THAT LOT 8097 & 8098 HEREON BE HELD IN THE SAME RECORD OF TITLE

THAT LOT 8099 & 8100 HEREON BE HELD IN THE SAME RECORD OF TITLE

THAT LOT 8101 & 8102 HEREON BE HELD IN THE SAME RECORD OF TITLE

THAT LOT 8103 & 8104 HEREON BE HELD IN THE SAME RECORD OF TITLE

THAT LOT 8105 & 8106 HEREON BE HELD IN THE SAME RECORD OF TITLE

THAT LOT 8107 & 8108 HEREON BE HELD IN THE SAME RECORD OF TITLE

THAT LOT 8109 & 8110 HEREON BE HELD IN THE SAME RECORD OF TITLE

THAT LOT 8111 & 8112 HEREON BE HELD IN THE SAME RECORD OF TITLE

THAT LOT 8113 & 8114 HEREON BE HELD IN THE SAME RECORD OF TITLE

THAT LOT 8115 & 8116 HEREON BE HELD IN THE SAME RECORD OF TITLE

THAT LOT 811 HEREON (LEGAL ACCESS) BE HELD AS TO TWO UNDIVIDED ONE HALF SHARES BY THE OWNERS OF LOTS 455 & 456 HEREON AND INDIVIDUAL RECORDS OF TITLE BE ISSUED IN ACCORDANCE THEREWITH.

THAT LOT 812 HEREON (LEGAL ACCESS) BE HELD AS TO TWO UNDIVIDED ONE HALF SHARES BY THE OWNERS OF LOTS 790 & 791 HEREON AND INDIVIDUAL RECORDS OF TITLE BE ISSUED IN ACCORDANCE THEREWITH.

SCHEDULE OF EXISTING EASEMENTS IN GROSS

PURPOSE	SHOWN	BURDENED LAND	GRANTEE	DOCUMENT NUMBER
RIGHT TO CONVEY TELECOMMUNICATIONS AND COMPUTER MEDIA	B	LOT 2 DP 534384	TRANSPOWER NEW ZEALAND LIMITED	EI 11070524.10
RIGHT TO CONVEY, DISCHARGE AND EARTH ELECTRICITY	M			EI 11070524.13
RIGHT TO CONVEY ELECTRICITY AND TELECOMMUNICATIONS	B & C			EI 11070524.14
RIGHT TO CONVEY ELECTRICITY FOR EARTHING PURPOSES	F			EI 11070635.1
RIGHT OF WAY	B			EI 11070524.15
RIGHT TO CONVEY TELECOMMUNICATIONS AND COMPUTER MEDIA	W & X		WEL NETWORKS LIMITED	EI 11070524.20

SCHEDULE OF PROPOSED EASEMENTS

PURPOSE	SHOWN	BURDENED LAND	BENEFITED LAND
ROW, RIGHT TO CONVEY ELECTRICITY, TELECOMMUNICATIONS, GAS, RIGHT TO DRAIN WATER AND SEWAGE	A1	LOT 8119 HEREON	LOTS 8012-8017 HEREON
	B1	LOT 8037 HEREON	LOTS 8031-8036 HEREON
	C1	LOT 8044 HEREON	LOTS 8038-8043 HEREON
	D1	LOT 8051 HEREON	LOTS 8045-8050 HEREON
	E1	LOT 8058 HEREON	LOTS 8052-8057 HEREON
	F1	LOT 8065 HEREON	LOTS 8059-8064 HEREON
	G1	LOT 201 HEREON	LOTS 8073-8100 HEREON
	H1	LOT 8124 HEREON	LOTS 8101-8116 HEREON
I1	LOT 811 HEREON	LOTS 455 & 456 HEREON	
J1	LOT 812 HEREON	LOTS 790 & 791 HEREON	

SCHEDULE OF EXISTING EASEMENTS

PURPOSE	SHOWN	BURDENED LAND	DOCUMENT NUMBER
RIGHT OF WAY	B	LOT 2 DP 534384	EI 11070524.17



SHRIMPTON & LIPINSKI

LAND DEVELOPMENT & DESIGN SPECIALISTS

Ph. 07 577 6069
Email: info@sltga.co.nz
P.O. Box 231, Tauranga 3140

www.sltga.co.nz

NOTES:

THIS PLAN HAS BEEN PREPARED FOR THE PURPOSES OF SECTION 88 OF THE RESOURCE MANAGEMENT ACT 1991 AND SHOULD NOT BE RELIED ON FOR ANY OTHER PURPOSE.

Rev	DESCRIPTION	DRN	CKD	APP	DATE
6	STGS 16, 20 & 21 AMENDED	NW	NF	NF	04/20
7	SECTION 92 RESPONSE	NW	JL	NF	08/20
8	LOT LAYOUT UPDATED 92	JL	JL	NF	08/20
9	LOT LAYOUT UPDATED 92	JL	JL	NF	08/20
10	LOT LAYOUT UPDATED 92	JL	JL	NF	08/20
11	LOT LAYOUT UPDATED 92	JL	JL	NF	08/20
12	SCHEME DETAIL UPDATED	NP	JL	NF	09/20

NAME	DATE	NAME	DATE
SURVEYED		DESIGNED	
COORDINATE SYSTEM: NZGD 2000 (MOUNT EDEN)			
ORIGIN OF COORDINATES:			
HEIGHT DATUM: MOUTRIKI LVD 1953			
ORIGIN OF HEIGHT:			

TITLE

AREAS LU & K SCHEME PLAN

PREPARED FOR



AREAS LU & K

ORIGINAL SCALES @ A3 STATUS

1:3000 FOR APPROVAL

DO NOT SCALE DIMENSIONS DRAWING NO REVISION

19-30410-LK-RC2 12